

- ✓ CUTTER 1100 W.
- ✓ 2 SPEEDS : 1500 RPM AND 3000 RPM.
- ✓ 5.8 LITRES STAINLESS STEEL TANK (RATED CAPACITY).
- ✓ 4.5 LITRES (OPERATING CAPACITY).
- ✓ SMOOTH BLADE (AS STANDARD).

ADVANTAGES

- **French design and manufacture, guaranteed quality, robustness and repairability - The DYNAMIC cutter is easily disassembled, repairable and reassembled. DYNAMIC guarantees the immediate availability of spare parts.**
- **Thanks to its unique design, this is an extremely versatile and aesthetic device. The design is based on users' real needs: the use of first quality materials (stainless steel), thought-out ergonomics, details and tips guaranteeing hygiene and safety (patent pending).**
- **A product designed with sustainable development in mind – 80% of the materials used are made from stainless steel and aluminium.**

DESCRIPTION



- Cutter for mixing, emulsifying, blending and chopping in seconds. Adjustable speed from 350 to 3500 rpm. PULSE and REVERSE functions. 5.8 Litre Stainless steel tank (rated capacity) + polycarbonate lid, equipped with an integrated manual wiper to avoid waste and for improved blending. Système de fixation rapide avec attaches clips (brevet déposé). Quick release system with clip fasteners (patent pending). Ability to add ingredients during preparation without opening the lid.
- A brushless induction motor, integrated in the metal motor block, with a power of 1100 W. Easy to use control panel.
- All parts in contact with food are easily removable and dishwasher-proof for quick cleaning.
- Magnetic detection which prevents the appliance from starting if an anomaly is detected. The appliance stops as soon as it detects any type of inappropriate use.
- WORKING CAPACITY: from 100g to 4kg.
- Supplied with a smooth blade with inverted cutters, enables you to save time and helps preserve sensory properties (patented system).

MAIN CHARACTERISTICS

- Cutter mixer, robust and reliable emulsifier for grinding, chopping, emulsifying and kneading.
- Supplied with a standard wiper.
- Adapted productivity for 20 to 100 covers per service.
- Removable, transparent lid with opening to add ingredients during preparation.
- All parts in contact with food are easily removable and dishwasher-proof.
- Easy to use waterproof control panel with on/off button, selected speed displayed 1 and 2 and "PULSE" and "REVERSE" functions. The "PULSE" function enables grinding and precision work, the "REVERSE" function enables gentle mixing and preserves the added ingredient entirely.
- Automatic magnetic detection on the stainless steel tank and lid for total operator safety.



2 SPEEDS CONTROL PANEL

CONSTRUCTION

- A brushless induction motor, integrated in the motor block, ensuring robustness and reliability over time.
- Integrated air vents on the motor unit for good engine ventilation.
- Extremely solid base.
- POWER: 1100 W – single-phase.
- 2 SPEEDS: 1500 R.P.M. et 3000 R.P.M.
- 5.8 Litre Stainless steel tank (rated capacity) or an operating capacity of 4.5 Litres.
- Polycarbonate lid without BPA (Bisphenol A).

ACCESSORIES INCLUDED

- 1 x stainless steel tank with a capacity of 5.8 litres.
- 1 x lid with integrated wiper for 5.8 litre stainless steel tank.
- 1 x smooth blade cutter.

OPTIONAL ACCESSORIES

- Serrated blade Cutter **reference CL8002** for herbs, crushing, spices, pastries ...

TECHNICAL SPECIFICATIONS

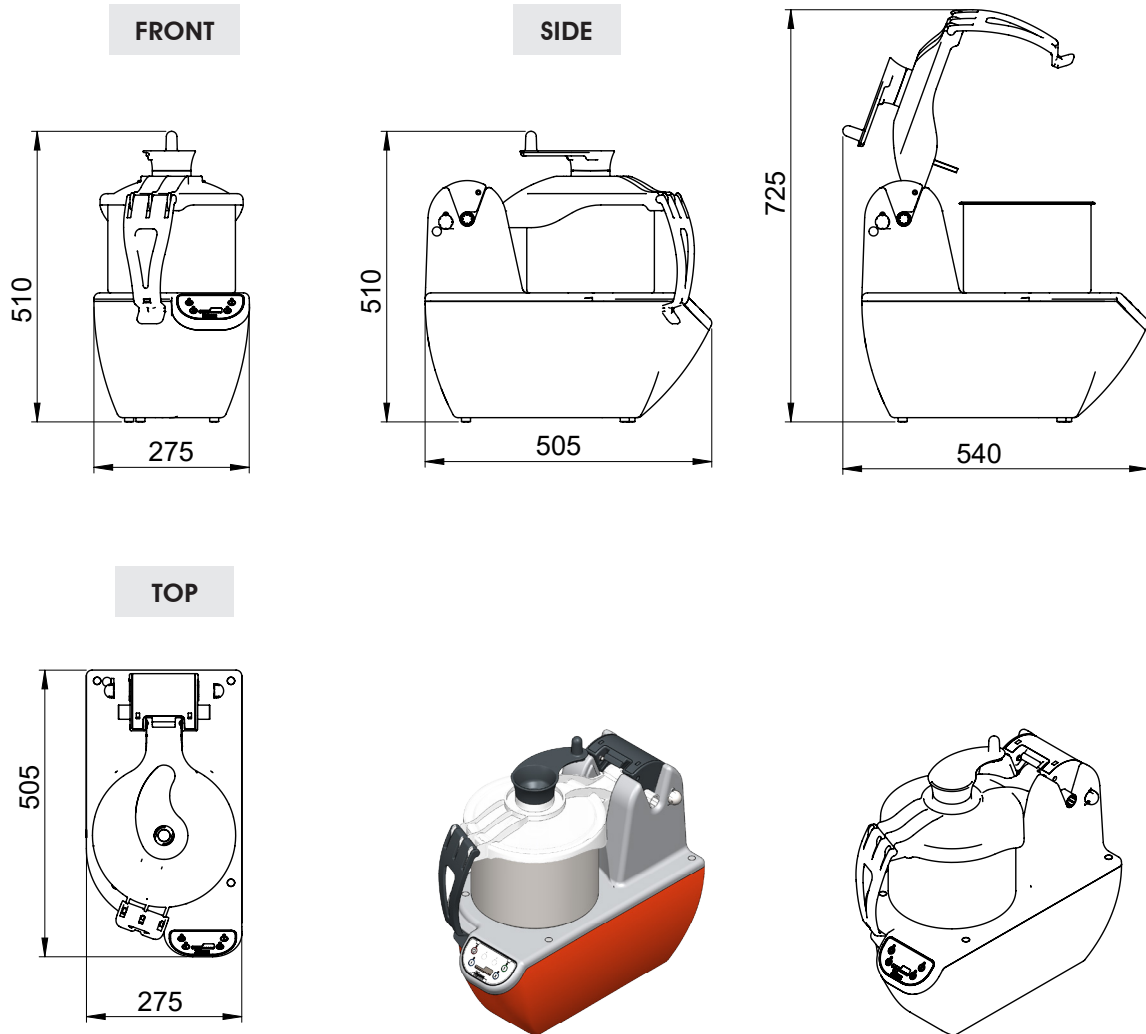

ELECTRICAL FEATURES

VOLTAGE	220 - 240 V / 50 - 60 Hz
POWER	1100 W

CUTTER CAPACITY

RATED CAPACITY	5.8 Litres
OPERATING CAPACITY	4.7 Litres

GENERAL INFORMATION

WIDTH	275 mm
HEIGHT	510 mm
DEPTH	505 mm